

CLUTCH

OUTLINE	6— 2
OUTLINE OF CONSTRUCTION	6— 2
SPECIFICATIONS	6— 2
INTERCHANGEABILITY OF MAJOR COMPONENTS	6— 2

67U06X-501

OUTLINE

OUTLINE OF CONSTRUCTION

The basic construction is the same as the previous model.

SPECIFICATIONS

		New model	Previous model
Clutch control type		Hydraulic	
Clutch cover	Spring type	Diaphragm	
	Outer diameter mm(in)	225 (8.86)	
	Inner diameter mm(in)	150 (5.91)	
Clutch disc	Thickness of pressure plate side	4.1 (0.16)	
	Thickness of flywheel side	3.5 (0.14)	

67U06X-502

INTERCHANGEABILITY OF MAJOR COMPONENTS

Parts interchangeability between the '86 RX-7 and '85 RX-7 are as show below:

symbols

O : interchangeable

X : not interchangeable

Part name	Interchangeability	Remark
Clutch cover	O	
Clutch disc	O	
Clutch release bearing	O	
Clutch release fork	O	
Clutch front cover	O	
Clutch master cylinder	X	To reduce weight the master cylinder is made of aluminum. To improve the serviceability, the mounting studs installation angle are changed to a 45° angle.
Clutch release cylinder	X	Installation position is changed.
Clutch pedal	X	To reduce weight, the pedal is made of aluminum.

67U06X-503

CONSTRUCTION

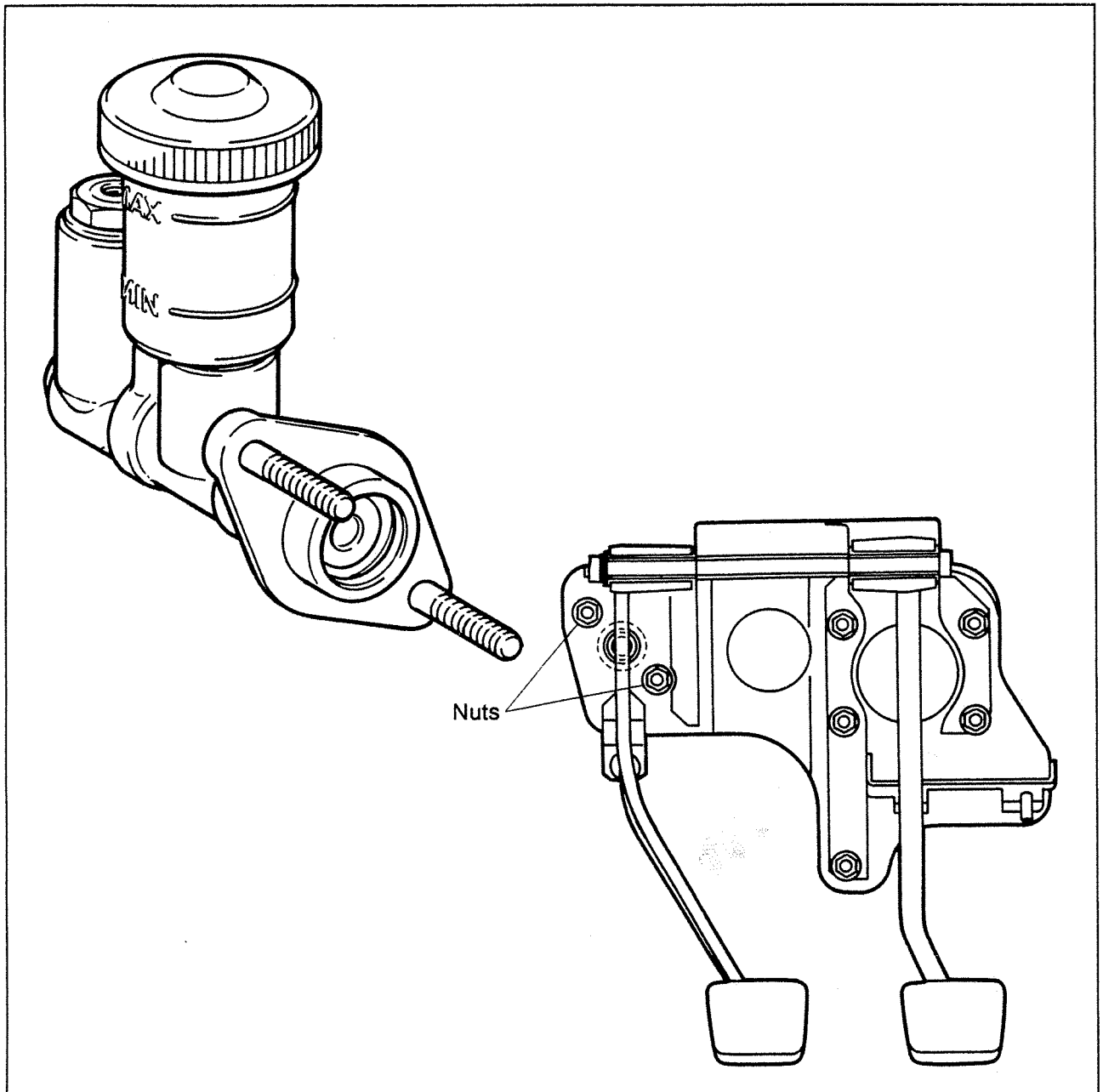

67U06X-504