

# CONVENTIONAL BRAKE SYSTEM

A5U041133980W02

## FRONT BRAKE (DISC) REMOVAL/INSTALLATION

1. Remove in the order indicated in the table.
2. Install in the reverse order of removal.

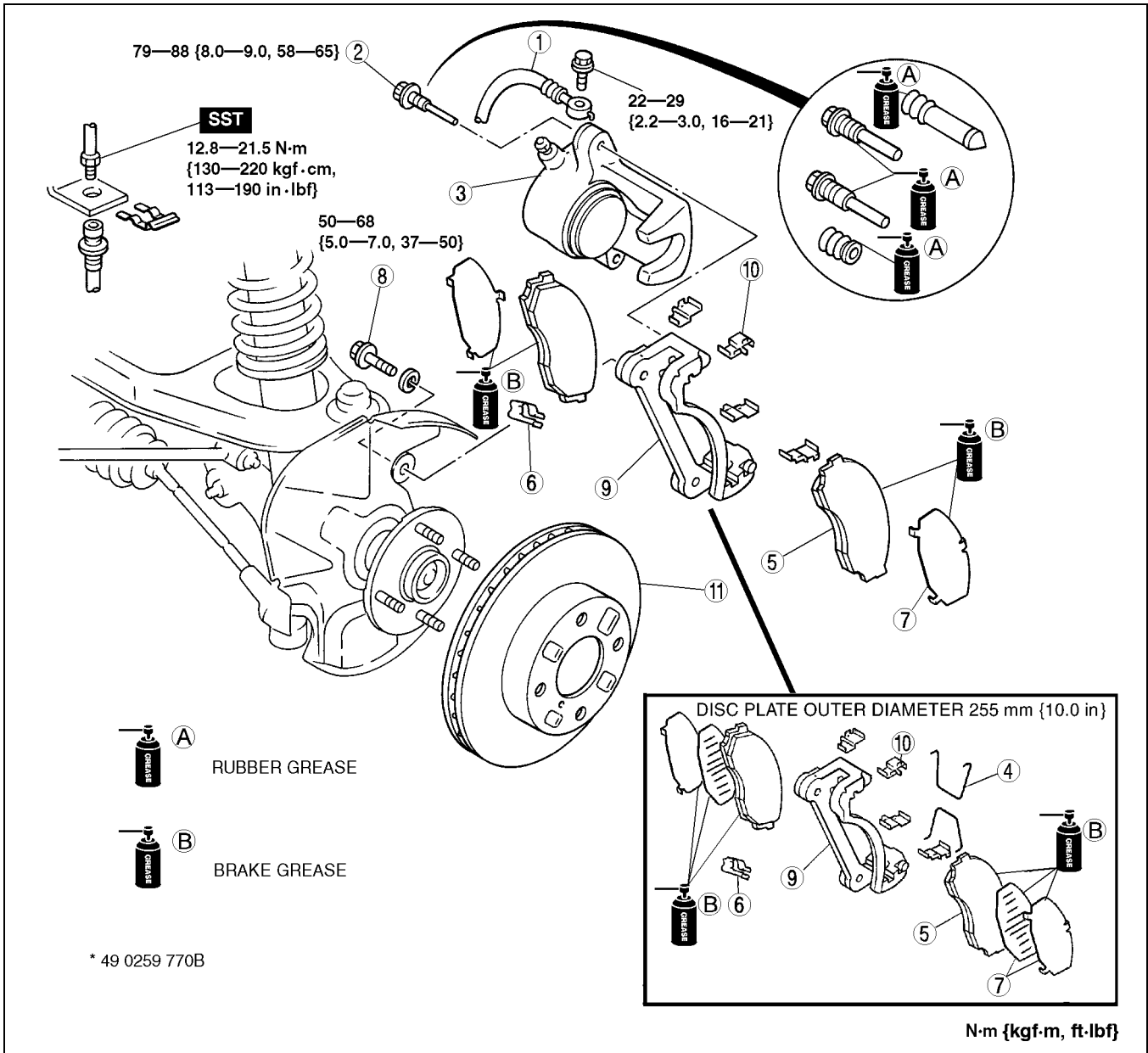

A5U0411W001

1	Brake hose
2	Lock bolt
3	Caliper
4	Spring (Disk plate outer diameter 255 mm {10.0 in})
5	Disc pad (See 04-11-17 Disc Pad Installation Note)
6	Pad wear indicator (RH side)

7	Shim
8	Bolt
9	Mounting support
10	Guide plate
11	Disc plate (See 04-11-17 Disc Plate Removal Note) (See 04-11-17 Disc Plate Installation Note)