

SHOCK ABSORBER AND SPRING

Removal / Installation

1. Jack up the front of the vehicle and support it with safety stands.
2. Remove the undercover.
3. Remove in the order shown in the figure, referring to **Removal Note**.
4. Inspect all parts and repair or replace as necessary.
5. Install in the reverse order of removal.
6. Tighten all nuts and bolts to the specified torques, referring to the figure.

Note

- Loosely tighten the shock absorber, upper arm, stabilizer control link, and stabilizer bracket bolts. Lower the vehicle and tighten all nuts and bolts to the specified torques with the vehicle unladen.

7. Adjust the front wheel alignment. (Refer to page R-6.)

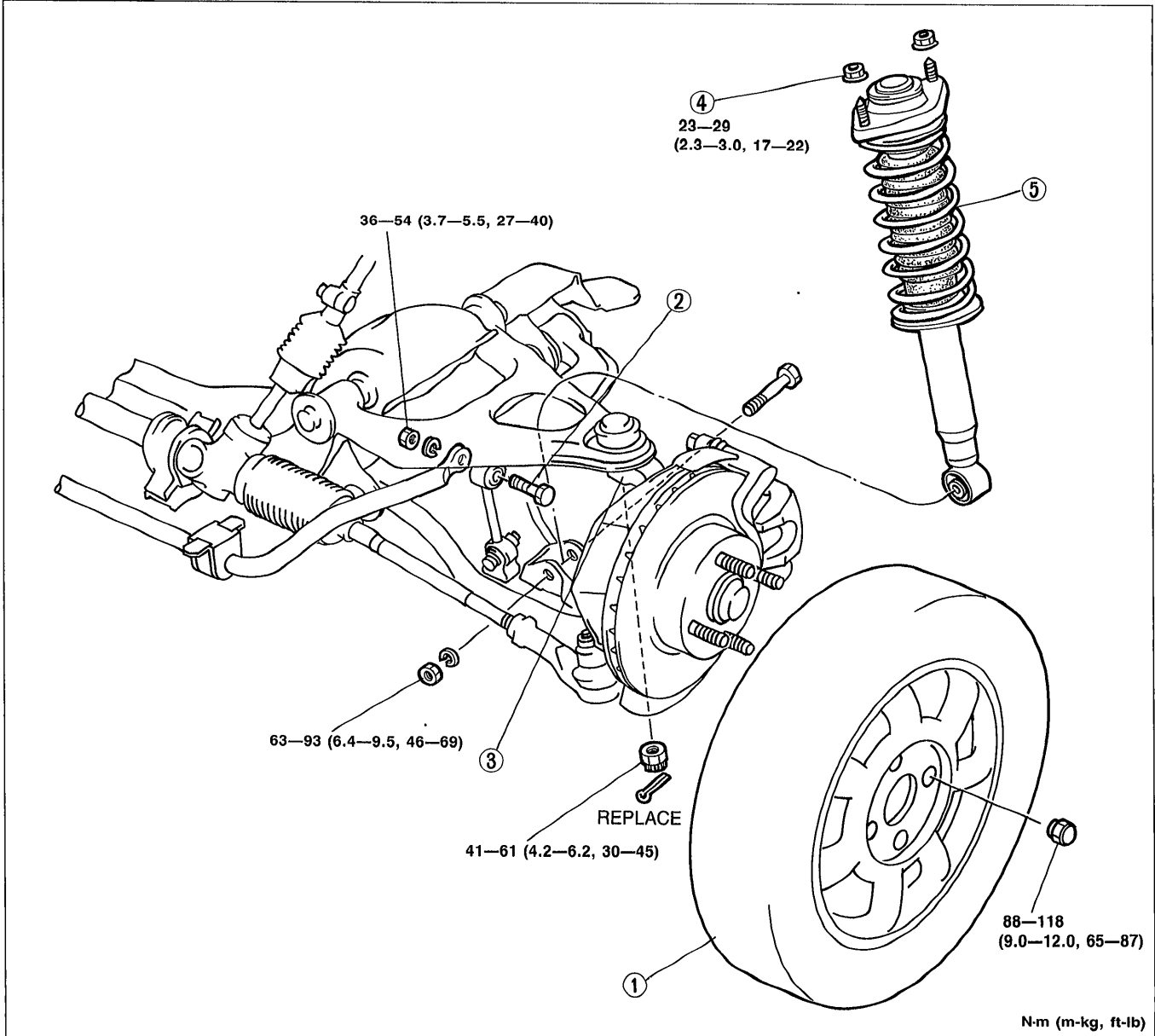

1. Wheel and tire
2. Stabilizer control link bolt
3. Upper arm ball joint
Removal Note..... page R-17

4. Mounting plate nut
5. Shock absorber and spring
Removal Note..... page R-13
Disassembly / Assembly page R-13