

### HLA Removal / Installation

#### Caution

- Removal and installation of the HLA must be carried out only when the problem cannot be solved by the HLA troubleshooting. (Refer to page B-9.)

- Disconnect the negative battery cable.
- Drain the engine coolant. (Refer to section E.)
- Remove in the order shown in the figure, referring to **Removal Note**.
- Install in the reverse order of removal, referring to **Installation Note**.

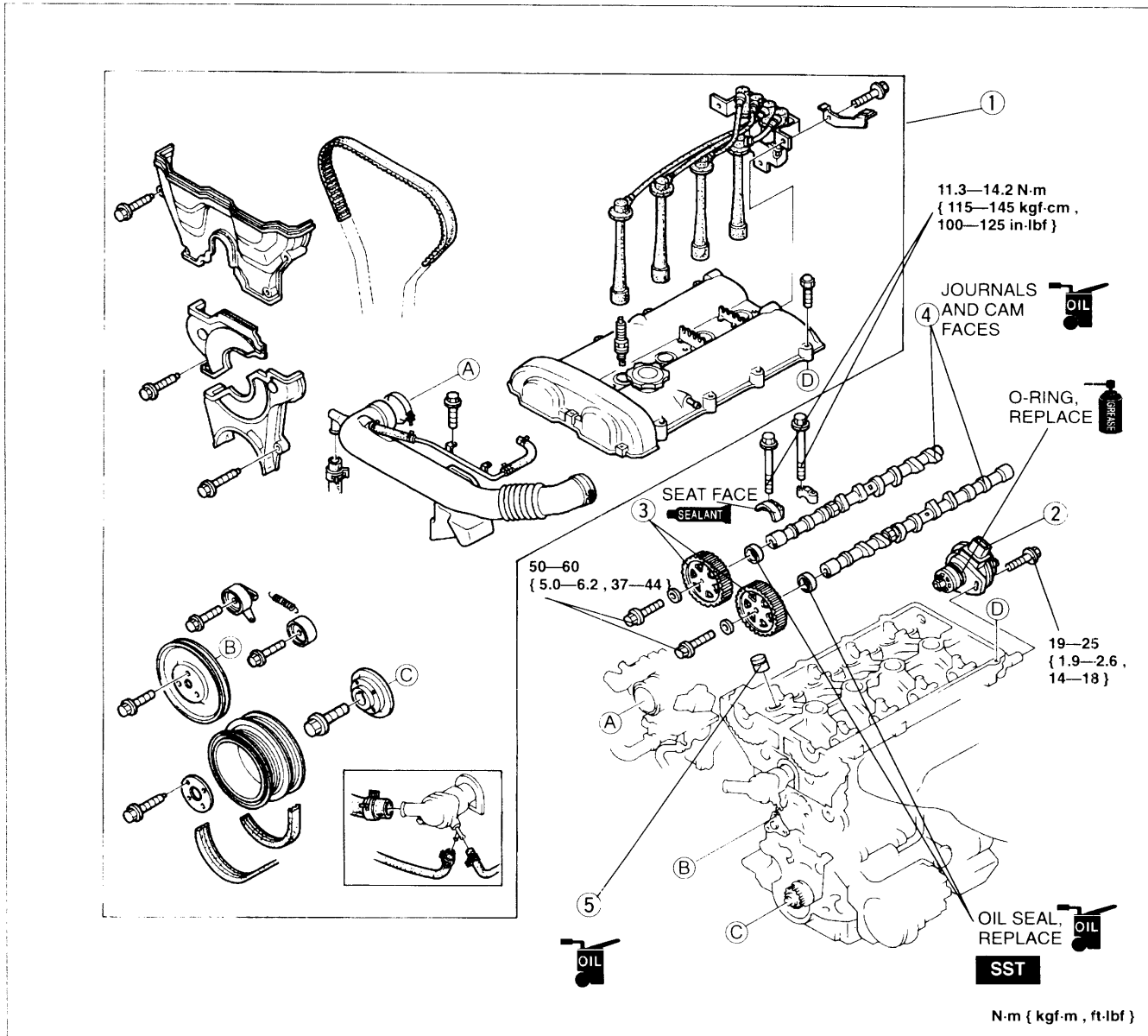

- |                             |           |
|-----------------------------|-----------|
| 1. Timing belt              |           |
| Removal / Installation      | page B-12 |
| 2. Camshaft position sensor |           |
| Installation Note           | section G |
| 3. Camshaft pulley          |           |
| Removal Note                | page B-21 |
| Installation Note           | page B-22 |

- |                   |           |
|-------------------|-----------|
| 4. Camshaft       |           |
| Removal Note      | page B-21 |
| Installation Note | page B-21 |
| 5. HLA            |           |
| Removal Note      | page B-21 |
| Installation Note | page B-21 |
| Inspection        | page B-53 |