



BRAKE SYSTEM

FRONT DISC BRAKE PADS

Removal & Installation

1) Raise and support v
Remove lower lock pin/guide bol

Fig. 6: Exploded View Of Front
Courtesy of Mazda Motors Corp.

2) Remove pads, shims,
Replace pad if lining thickness
MINIMUM PAD LINING SPECIFICATIO
3) To install, reverse
Expander (49-0221-600C) to push
pads.

MINIMUM PAD LINING SPECIFICATIO

Application

Miata

FRONT DISC BRAKE CALIP

Removal & Installation

Raise and support vehi
disconnect brake hose. Plug all
pads. See **FRONT DISC BRAKE PADS**
Remove caliper from vehicle. To
Bleed air from system.

FRONT BRAKE ROTOR

Removal & Installation

1) Raise and support v

Fig. 6: Exploded View Of Front Disc Brake Assembly
Courtesy of Mazda Motors Corp.

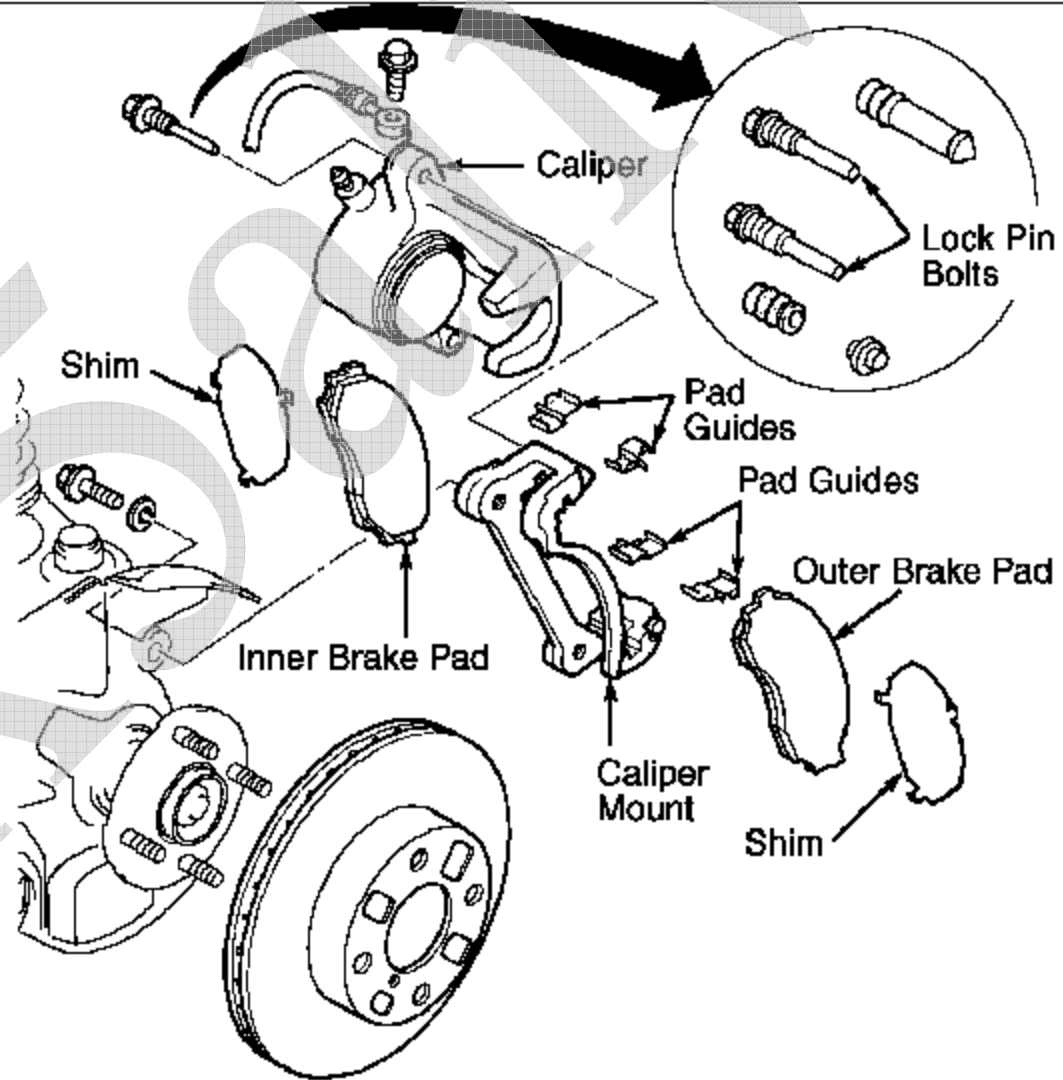

G91B00829