



1.8L 4-CYLINDER

N.m). To complete installat.
bolts to specification. See

OIL PUMP SPECIFICATIONS

Application

Maximum Rotor Side Clearance
Maximum Rotor Tip Clearance
Maximum Rotor-To-Pump Body
Clearance (3)
Pressure Relief Spring Leng

- (1) - Insert feeler gauge b
- (2) - Place straightedge ac
between straightedge :
- (3) - See Fig. 40.
- (4) - Using 14.1-15.4 lbs.

Fig. 39: Exploded View Of
Courtesy of Mazda Motors Co.

Fig. 40: Aligning Marks On
Courtesy of Mazda Motors Co.

TORQUE SPECIFICATIO

TORQUE SPECIFICATIONS

Application

Axle Shaft Nut (Protege)
Camshaft Sprocket Bolt ...
Compressor Bracket-To-Engin
Connecting Rod Cap Nuts ...

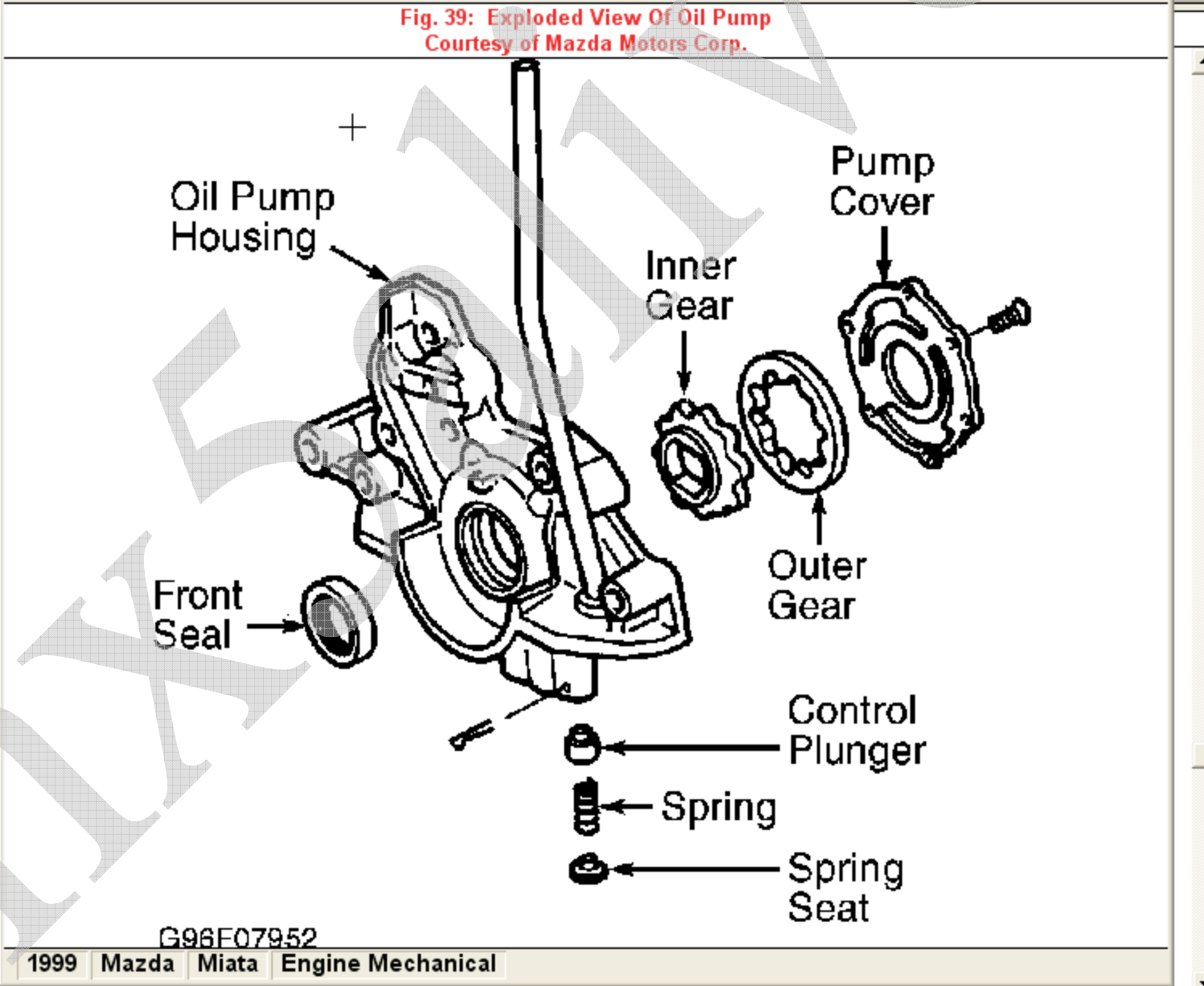

G96F07952